



d-flexx



CERTIFIED
PAS
★ ★ ✓ ★ ★

FOXTROT

Machine Guard

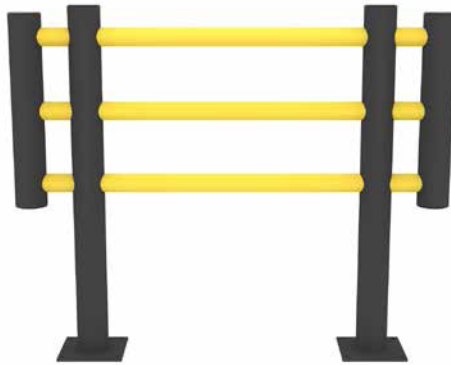

Tested Impact Energy
according to **PAS13**

17.000 Joule

At 22.5° Impact, 3.6 km/h
(2,24 mph) and 3.150 kg (6945 lbs)
on a C20/25 concrete floor and
max. force to bolt at 13 kN.

Description

The FOXTROT Barrier is an essential safety solution designed to prevent accidents by shielding machine operators from unintentionally entering vehicle traffic zones. In addition, it protects critical machinery from minor, low-impact collision damage. This barrier provides both a physical and visual safeguard, ensuring a safer and more controlled environment in industrial facilities.

This barrier is fully compliant with PAS13, adhering to the guidelines for safe practices in workplaces, specifically in managing the separation between pedestrian workers and vehicle traffic.

The FOXTROT Barrier is critical for maintaining the safety of machine operators in busy industrial environments. By preventing accidental access to vehicle pathways, it minimizes the risk of collisions and injuries, ensuring a safer workspace. Additionally, the barrier protects valuable machinery from damage, helping to prevent costly repairs and downtime.

Technical Information

Operational Temperature Range:	-40°C up to +50°C / -40°F up to +112°F
Ignition Temperature:	350-360°C / 662 - 680°F
Flash Point:	350-360°C / 662 - 680°F
Toxicity:	Nontoxic
Chemical Resistance:	High-ISO / TR 10358
UV Stability	Gray scale: 5/5
Changes to material after 5 years:	Blue Wool scale: 8/8 Tensile strength: No changes
Static Rating (surface resistivity):	1015-1016 Ω
Standard Warranty:	5 Years
Fixations:	Concrete screw, Zinc coated, Size Ø10x70 mm
Deflection zone:	250mm / 9,84in

Scan or click to review



*Maintenance Guide
Assembly Guide
Videos
Tender Text
Warranty*



Specifications

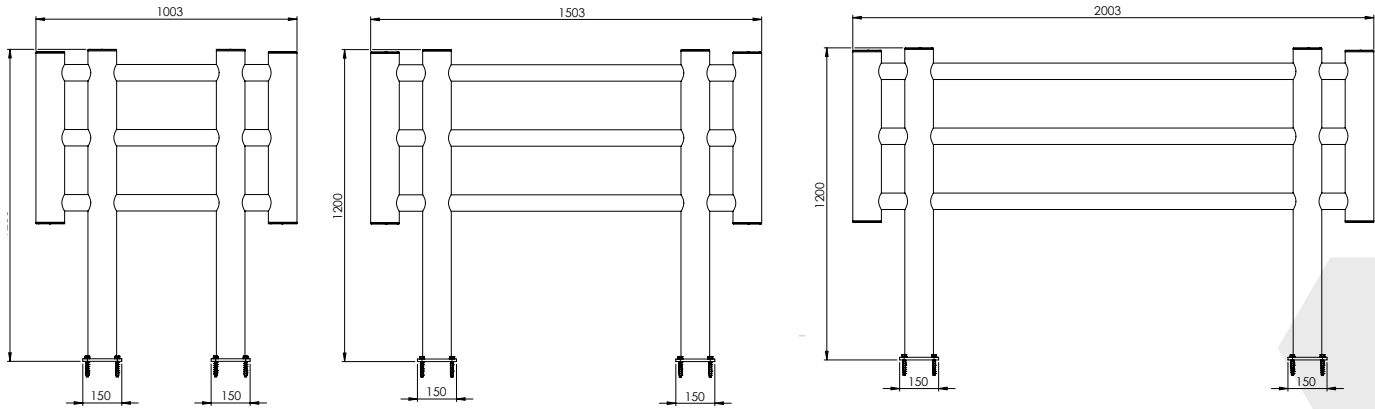
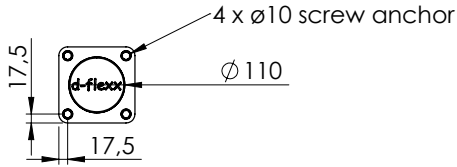

Measurements mm vs in

	mm	in
Diameter	110	4,33
Height	1200	47,24
Width 1	1003	39,52
Width 2	1503	59,21
Width 3	2003	78,94
Footplate	150	5,91
Pos. drill holes	17,5	0,69

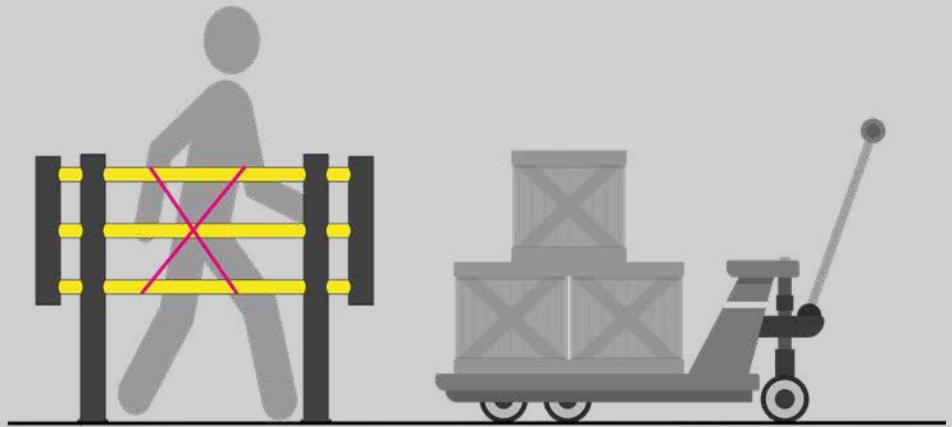

Max. force to bolt 13 kN

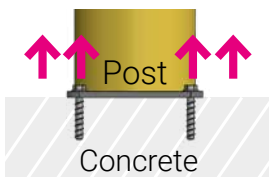

Impact Test FOXTROT

Mid Rail Max. Energy (Joules)	90°	67,5°	45°	22,5°
	2.500	2.900	5.000	17.000

End post max. energy (Joules) - 90° 2.500